

CAL. YM92

1/20 SECOND CHRONOGRAPH

1/4 Instructions

Features

- ◆ Hour, Minute and Small second hands
- ◆ Date
- ◆ Stopwatch
 - 4 Stopwatch hands: 1/20-second, Second, Minute and Hour hand.
 - The stopwatch can measure up to 11:59' 59" 95.
 - Sprit time measurement.

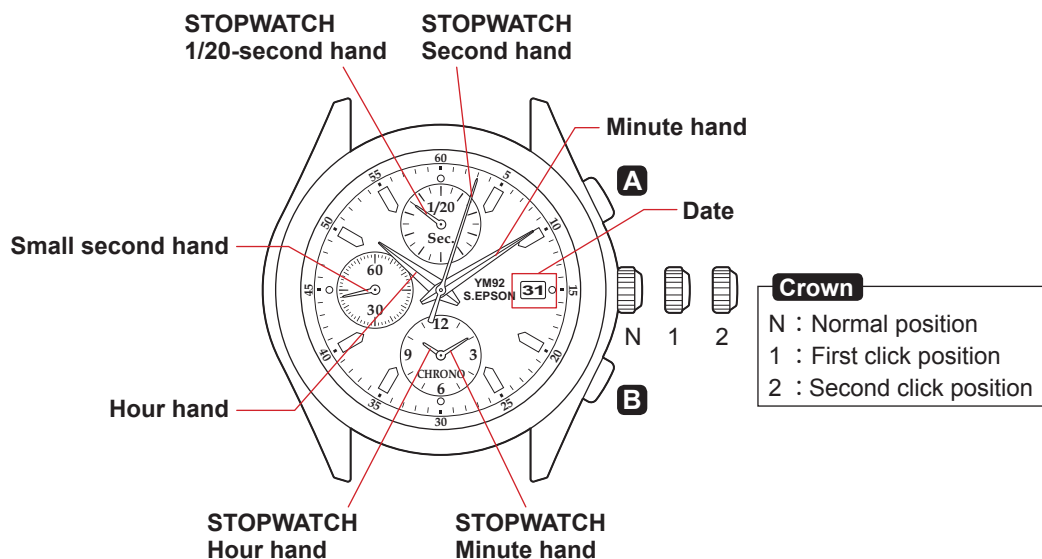

Movement Size	12 ^{'''}
Outside Diameter	27.60 mm (12H-6H) x 24.00 mm (3H-9H)
Casing Diameter	27.00 mm (12H-6H)
Height	3.70 mm (Include battery)
Battery	SR927SW
Battery Life Approx.	3 years

◆ Battery Life Indicator

When the battery nears its end, the small second hand moves at two-second intervals instead of normal one-second intervals. In that case, have the battery replaced with a new one as soon as possible.

Note: The watch remains accurate while the small second hand is moving at two-second intervals.



S.EPSON Products

JAPAN TECHNOLOGY & QUALITY

www.timemodule.com

How to Set Time and Date:

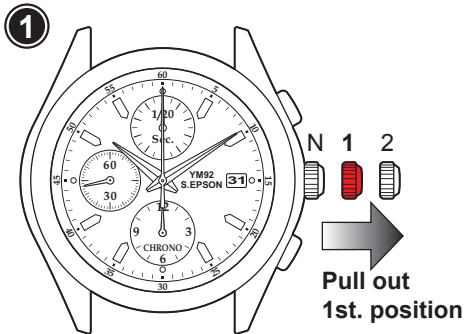

- Pull crown out to 1st. click position.

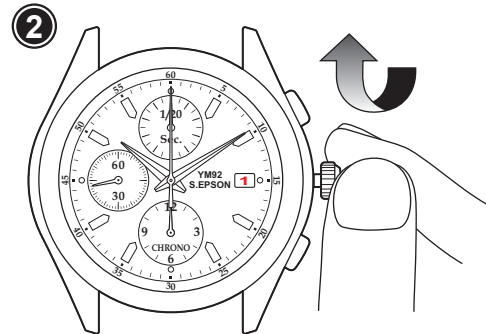

- Turn the crown clockwise until the previous day's date appears.

Note: Do not set the date between 9:00 PM and 1:00 AM. Otherwise, the date may not change properly.

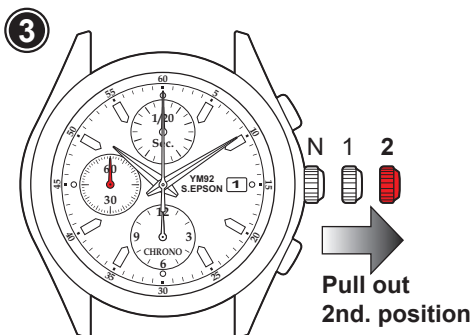

- Pull crown out to the 2nd click position when the second hand is at the 12 o'clock position.

Note: When the stopwatch is or has been measuring or is stopped, if the crown is pulled out to the 2nd. click position, it will automatically reset the Stopwatch hands to "0".

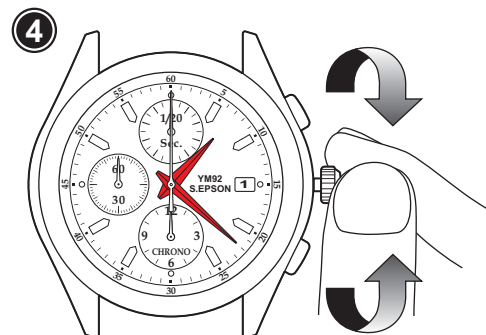

- Turn to set the Hour and Minute hands.
- Turn clockwise to advance the Hour and Minute hands past 12:00 AM. Doing so will advance the date to the current date.
- Set the Hour and Minute hands to the desired time taking AM or PM into consideration.

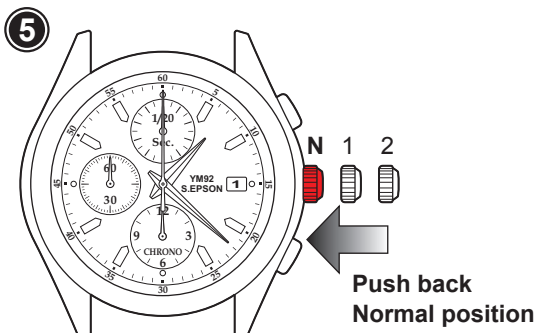

- Push crown back to normal position.

Recommend:

- When setting the Minute hand, first advance it 4 to 5 minutes ahead of the desired time and then turn it back to the exact minute.

CAL. YM92

1/20 SECOND CHRONOGRAPH

3/4 Instructions

How to Use Stopwatch Functions:

The stopwatch can measure up to 11:59' 59" 95 in 1/20 second increments.

When the measurement reaches 12 hours, the stopwatch automatically stops counting.

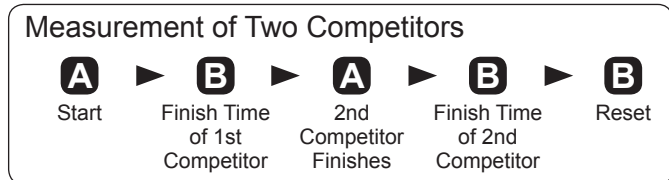
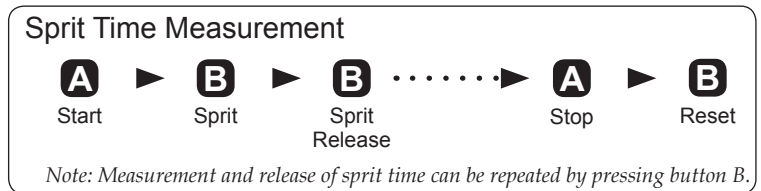
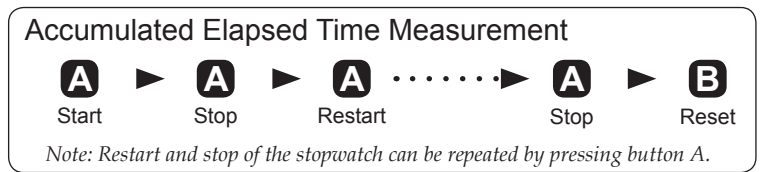
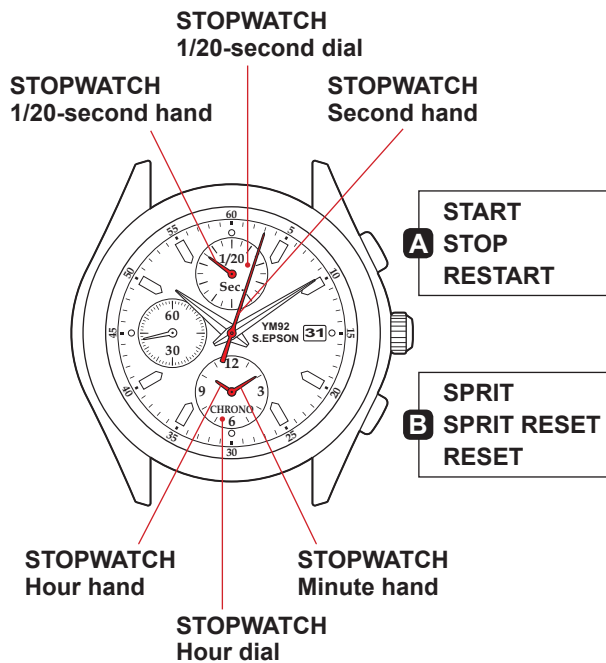

- 1/20-second hand is capable of timing 12 minutes. (1 second x 43,200 times)
- Second hand is capable of timing 12 hours. (60 seconds x 720 times)

◆ Movement of Stopwatch 1/20-second hand

- After the stopwatch is started, Stopwatch 1/20-second hand moves for about 10 minutes and automatically stops at the "0" position.
- When the measurement is stopped or split time is measured, it moves to indicate the elapsed 1/20 seconds.
- After the stopwatch is restarted or split time is released, Stopwatch 1/20-second hand moves for about 10 minutes and stops automatically.
- In the same manner, if the stopwatch is stopped and restarted repeatedly or split time is measured and released repeatedly, Stopwatch 1/20-second hand moves for about 10 minutes and stops automatically.

* Before using the stopwatch, be sure to check that the crown is set at the normal position and that the Stopwatch hands are reset to the "0" position.

Note: If the Stopwatch hands do not return to the "0" position when the stopwatch is reset to "0", follow the procedure in "Stopwatch Hand Position Adjustment".



S.EPSON Products

JAPAN TECHNOLOGY & QUALITY

www.timemodule.com

CAL. YM92

1/20 SECOND CHRONOGRAPH

4/4 Instructions

Stopwatch Hand Position Adjustment:

If the Stopwatch hands are not in "0" position, follow the procedures below to set them.

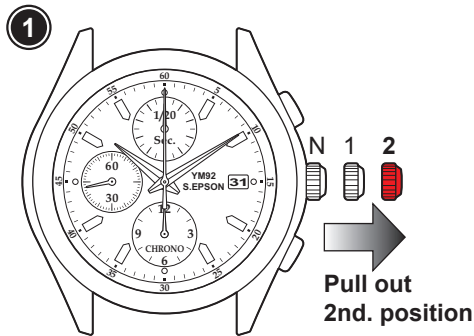

- Pull the crown out to 2nd. click position.

Note: When the stopwatch is or has been measuring or is stopped, if the crown is pulled out to the 2nd. click position, it will automatically reset.

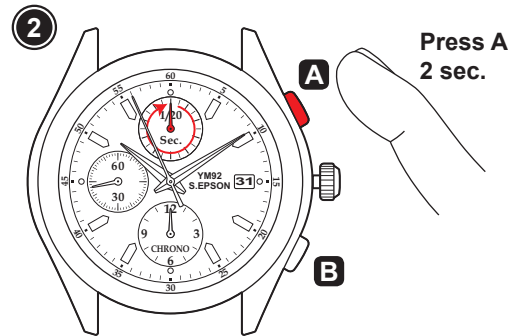

- Press button "A" for 2 seconds.
 - Stopwatch 1/20-second hand turns a full round and can now be set to correct position.
- Press button "B" repeatedly to set it to "0" position.

Note: Stopwatch 1/20-second hand moves quickly if button "B" is kept pressed.

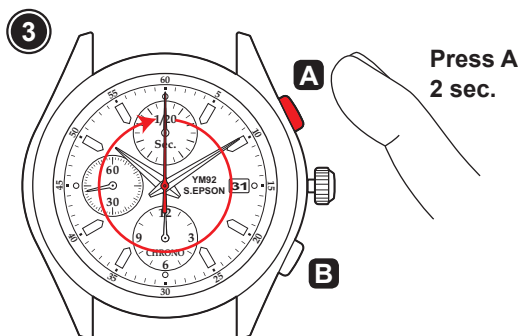

- Press button "A" for 2 seconds.
 - Stopwatch Second hand turns a full round and can now be set to correct position.
- Press button "B" repeatedly to set it to "0" position.

Note: Stopwatch Second hand moves quickly if button "B" is kept pressed.

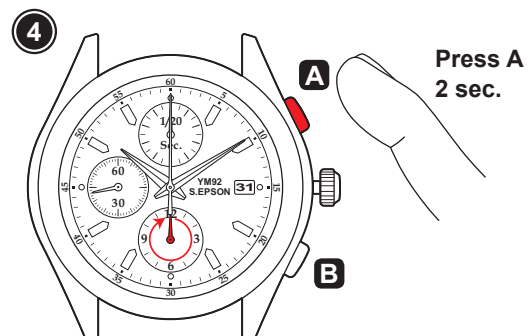

- Press button "A" for 2 seconds.
 - Stopwatch Hour and Minute hands turn and can now be set to correct position.
- Press button "B" repeatedly to set it to "0" position.

Note: Stopwatch Hour and Minute hands move quickly if button "B" is kept pressed.

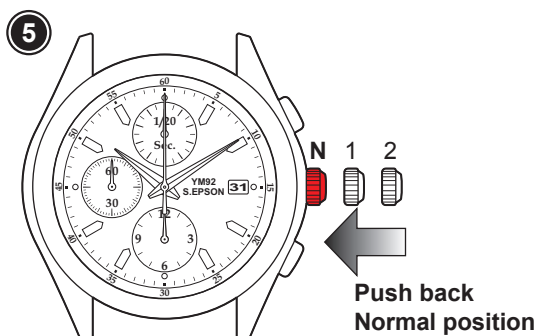

- Push crown back to normal position.

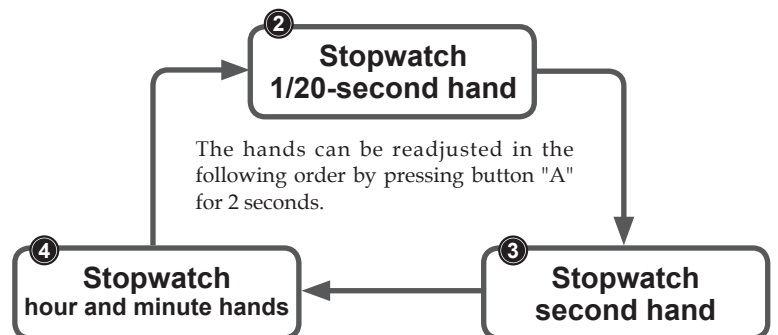

S.EPSON Products

JAPAN TECHNOLOGY & QUALITY

www.timemodule.com