

CAL. YM91

1/5 SECOND CHRONOGRAPH

1/4 Instructions

Features

- ◆ Hour, Minute and Small second hands
- ◆ Date
- ◆ Stopwatch
 - 2 Stopwatch hands: 1/5-second, Minute hand.
 - The stopwatch can measure up to 59' 59" 80.
 - Sprit time measurement.

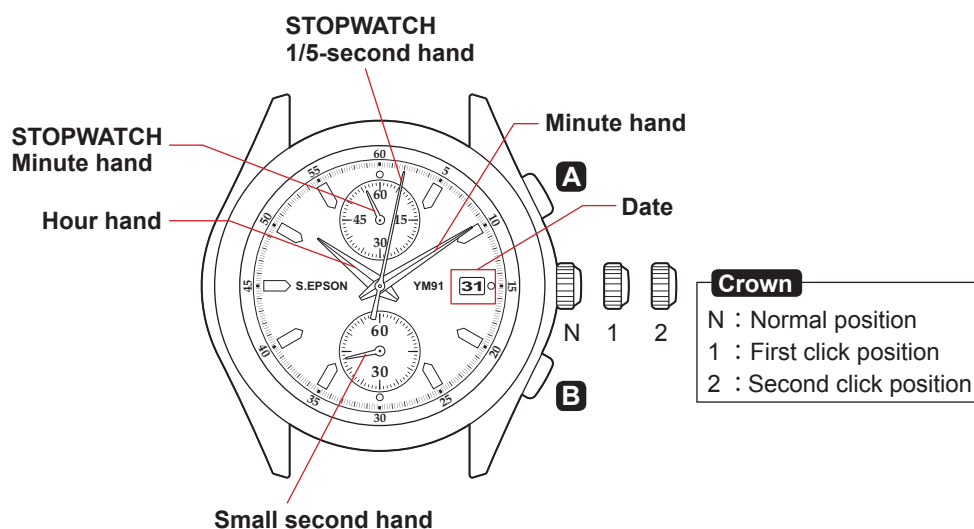

Movement Size	12'''
Outside Diameter	27.60 mm (12H-6H) x 24.00 mm (3H-9H)
Casing Diameter	27.00 mm (12H-6H)
Height	3.70 mm (Include battery)
Battery	SR927SW
Battery Life Approx.	5 years

◆ Battery Life Indicator

When the battery nears its end, the small second hand moves at two-second intervals instead of normal one-second intervals. In that case, have the battery replaced with a new one as soon as possible.

Note: The watch remains accurate while the small second hand is moving at two-second intervals.



S.EPSON Products

JAPAN TECHNOLOGY & QUALITY

www.timemodule.com

How to Set Time and Date:

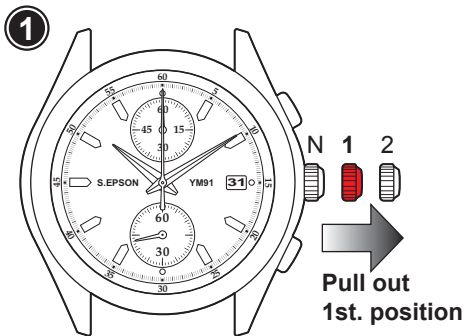

- Pull crown out to 1st. click position.

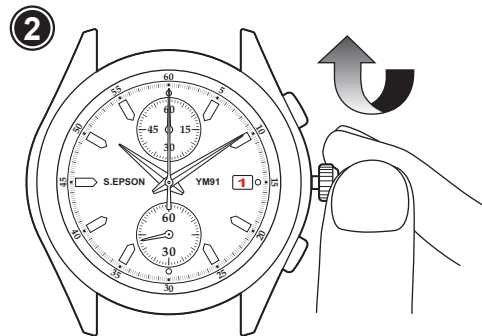

- Turn the crown clockwise until the previous day's date appears.

Note: Do not set the date between 9:00 PM and 1:00 AM. Otherwise, the date may not change properly.

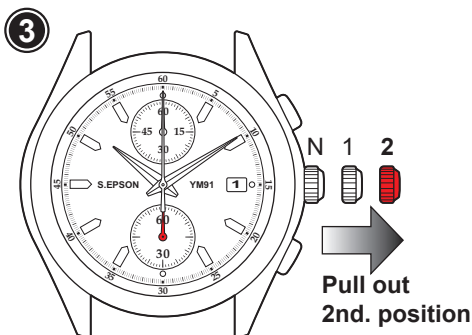

- Pull crown out to the 2nd click position when the second hand is at the 12 o'clock position.

Note: When the stopwatch is or has been measuring or is stopped, if the crown is pulled out to the 2nd. click position, it will automatically reset the Stopwatch hands to "0".

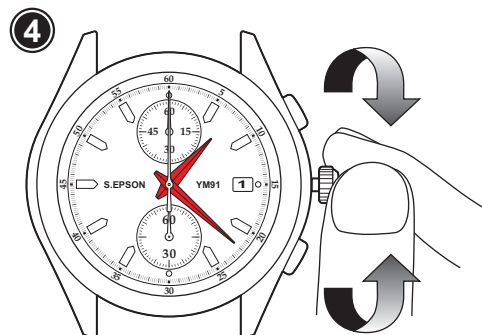

- Turn to set the Hour and Minute hands.
- Turn clockwise to advance the Hour and Minute hands past 12:00 AM. Doing so will advance the date to the current date.
- Set the Hour and Minute hands to the desired time taking AM or PM into consideration.

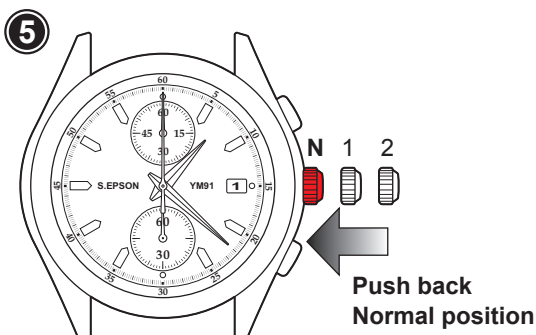

- Push crown back to normal position.

Recommend:

- When setting the Minute hand, first advance it 4 to 5 minutes ahead of the desired time and then turn it back to the exact minute.



How to Use Stopwatch Functions:

The stopwatch can measure up to 59' 59" 80 in 1/5 second increments.

When the measurement reaches 12 hours, the stopwatch automatically stops counting.

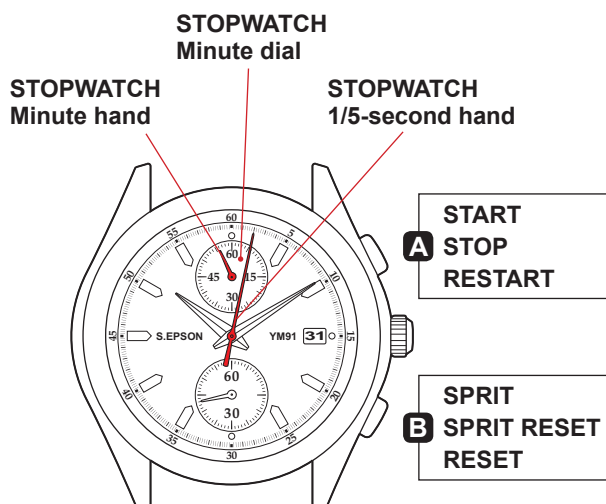

Standard Measurement



Accumulated Elapsed Time Measurement



Note: Restart and stop of the stopwatch can be repeated by pressing button A.

Sprit Time Measurement



Note: Measurement and release of sprit time can be repeated by pressing button B.

Measurement of Two Competitors



- 1/5-second hand is capable of timing 12 hours. (60 seconds x 720 times)
- Minute hand is capable of timing 12 hours. (60 minutes x 12 times)

* Before using the stopwatch, be sure to check that the crown is set at the normal position and that the Stopwatch hands are reset to the "0" position.

Note: If the Stopwatch hands do not return to the "0" position when the stopwatch is reset to "0", follow the procedure in "Stopwatch Hand Position Adjustment".



Stopwatch Hand Position Adjustment:

If the Stopwatch hands are not in "0" position, follow the procedures below to set them.

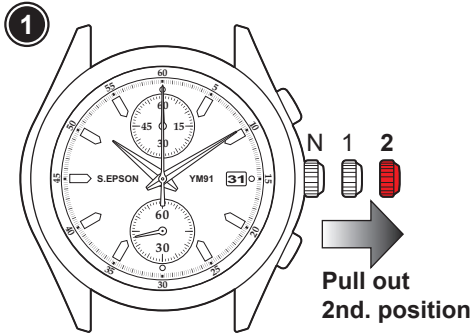

- Pull the crown out to 2nd. click position.

Note: When the stopwatch is or has been measuring or is stopped, if the crown is pulled out to the 2nd. click position, it will automatically reset.

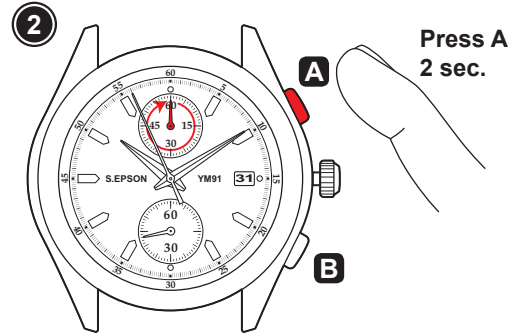

- Press button "A" for 2 seconds.
 - Stopwatch minute hand turns a full round and can now be set to correct position.
- Press button "B" repeatedly to set it to "0" position.

Note: Stopwatch minute hand moves quickly if button "B" is kept pressed.

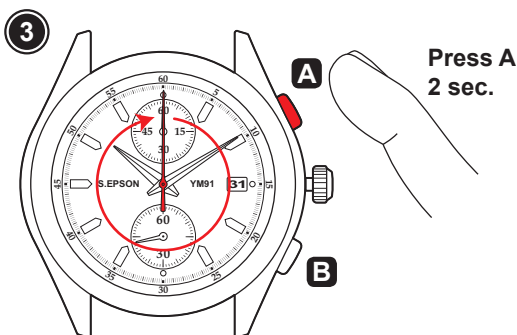

- Press button "A" for 2 seconds.
 - Stopwatch 1/5-Second hand turns a full round and can now be set to correct position.
- Press button "B" repeatedly to set it to "0" position.

Note: Stopwatch 1/5-second hand moves quickly if button "B" is kept pressed.

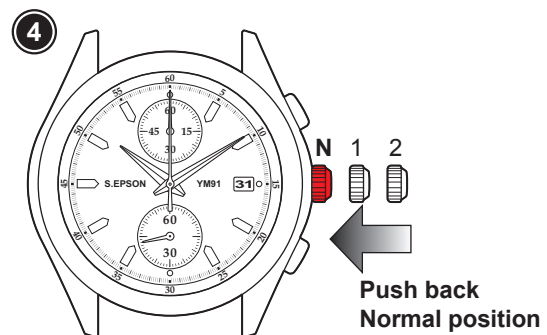

- Push crown back to normal position.