

CAL.YM89

1/5 SECOND CHRONOGRAPH WITH COUNTDOWN TIMER

1/6 Instructions

Features

- ◆ 24-hour, Hour, Minute and Small second hands
- ◆ Big Date
- ◆ Stopwatch
 - 2 Stopwatch hands: 1/5-second and Minute hand.
 - The stopwatch can measure up to 45 minutes.
 - Sprit time measurement.
- ◆ Countdown timer
 - The countdown timer can be set 1 to 45 minutes with beep sound.

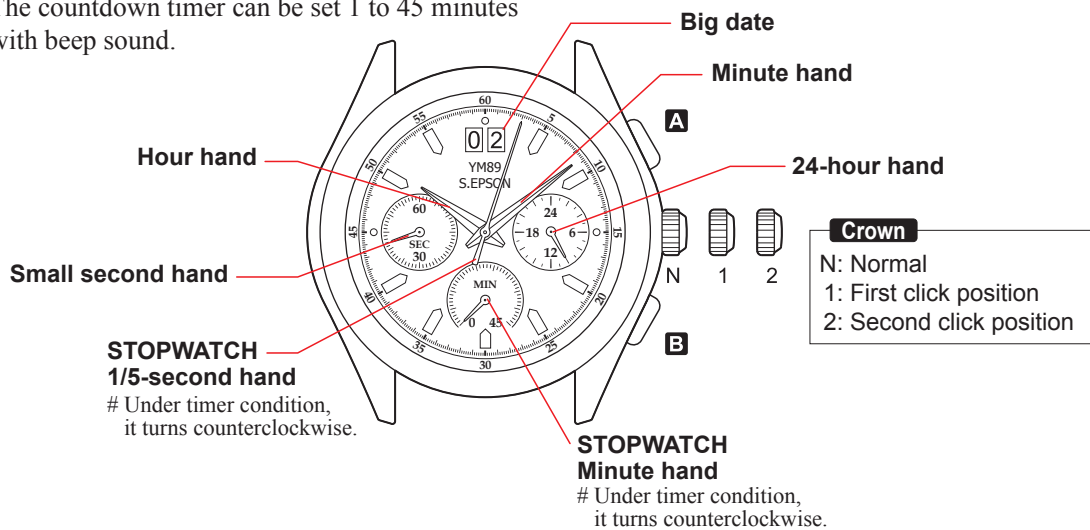

Movement size	12'''
Outside Diameter	27.60 mm (12H-6H) X 24.00 mm (3H-9H)
Casing Diameter	27.00 mm (12H-6H)
Height	5.01 mm (Including Battery)
Battery	SR927W
Battery Life Approx.	3 years

◆ Battery Life Indicator

When the battery nears its end, the small second hand moves at two-second intervals instead of normal one-second intervals. In that case, have the battery replaced with a new one as soon as possible.

Note: The watch remains accurate while the small second hand is moving at two-second intervals.



S.EPSON Products

JAPAN TECHNOLOGY & QUALITY

www.timemodule.com

CAL.YM89

1/5 SECOND CHRONOGRAPH WITH COUNTDOWN TIMER

2/6
Instructions

How to Set Time and Date:

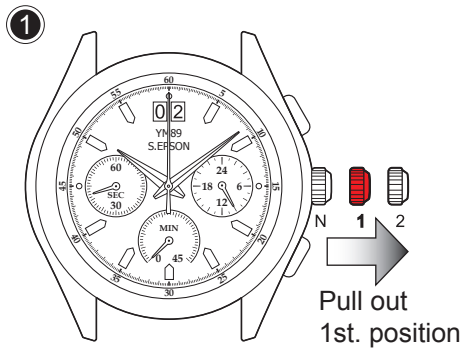

- Pull crown out to the 1st click position.

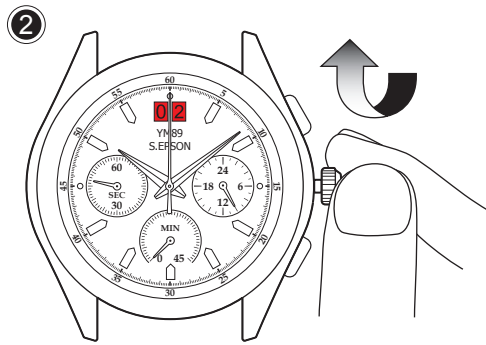

- Turn the crown clockwise until the previous day's date appears.

*Note: Do not set the date between 9:00 PM and 1:00 AM.
Otherwise, the date may not change properly.
Next of 31st becomes 01st.
Please turn crown slowly in order to avoid trouble.*

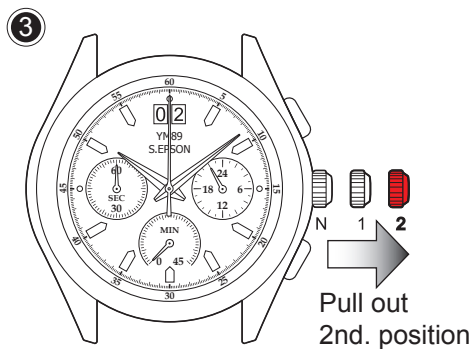

- Pull crown out to the 2nd click position when the second hand is at the 12 o'clock position.

Note: When the stopwatch has been measuring or is stopped, if the crown is pulled out to the 2nd. click position, it will automatically reset the Stopwatch hands to "0".

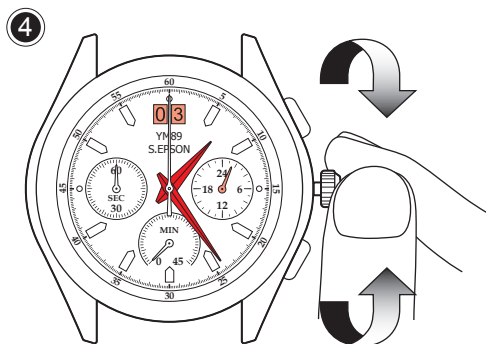

- Turn to set the Hour and Minute hands.
- Turn clockwise to advance the Hour and Minute hands past 12:00 AM. Doing so will advance the date to the current date.
- Set the Hour and Minute hands to the desired time taking AM or PM into consideration. You can confirm with 24 hour hand.

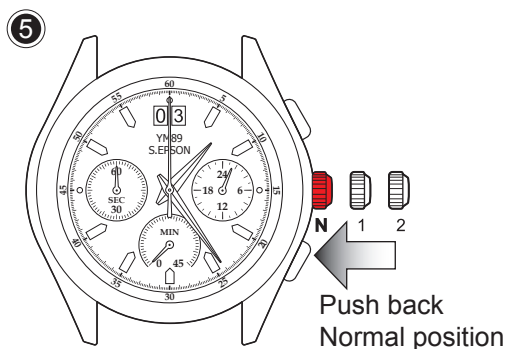

- Push crown back to normal position.

Recommend:

- The hands be set to the time a few minutes ahead of the current time, taking into consideration the time required to adjust the Stopwatch hands position if necessary.
- When setting the Minute hand, first advance it 4 to 5 minutes ahead of the desired time and then turn it back to the exact minute.



S.EPSON Products

JAPAN TECHNOLOGY & QUALITY

www.timemodule.com

CAL.YM89

1/5 SECOND CHRONOGRAPH WITH COUNTDOWN TIMER

How to Use Stopwatch Functions:

The stopwatch can measure up to 45 minutes in 1/5 second increments.

When the measurement reaches 45 minutes, the stopwatch automatically stops counting.

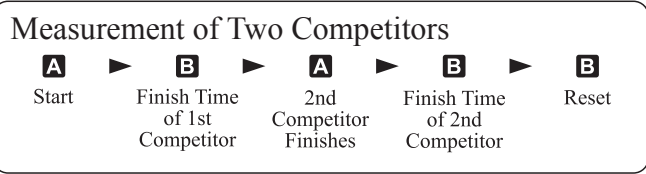
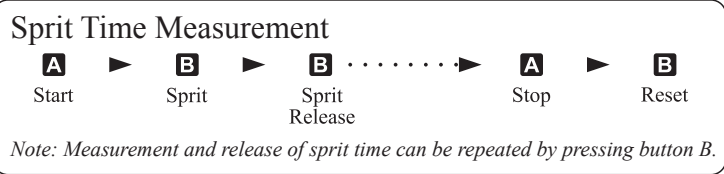
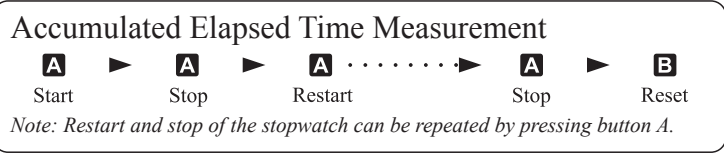
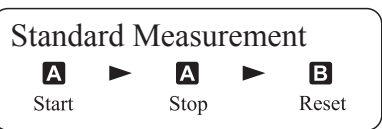
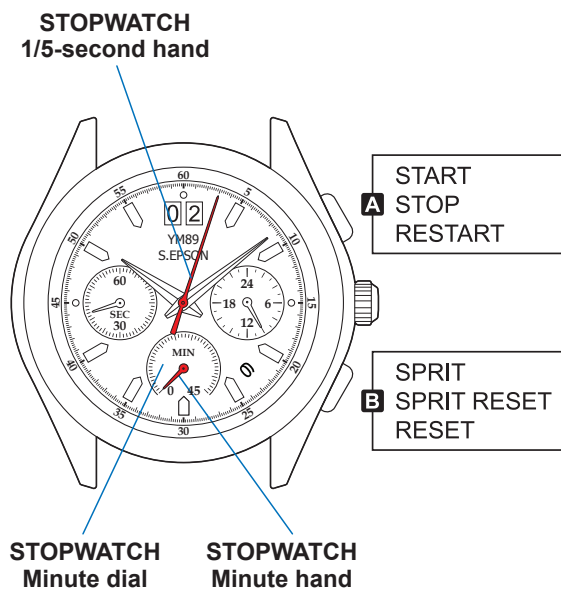

- 1/5-second hand is capable of timing 45 minutes. (60 seconds x 45 times)
- Minute hand is capable of timing 45 minutes.

* Before using the stopwatch, be sure to check that the crown is set at the normal position and that the Stopwatch hands are reset to the “0” position.

Note: If the Stopwatch hands do not return to the “0” position when the stopwatch is reset to “0”, follow the procedure in “Stopwatch Hand Position Adjustment”.



S.EPSON Products

JAPAN TECHNOLOGY & QUALITY

www.timemodule.com

CAL.YM89

1/5 SECOND CHRONOGRAPH WITH COUNTDOWN TIMER

4/6 Instructions

How to Use Countdown Timer Function:

- This is one time countdown timer. When the timer finishes counting down, the timer is automatically canceled. It is necessary to set the time before use.

How to Set Countdown Timer:

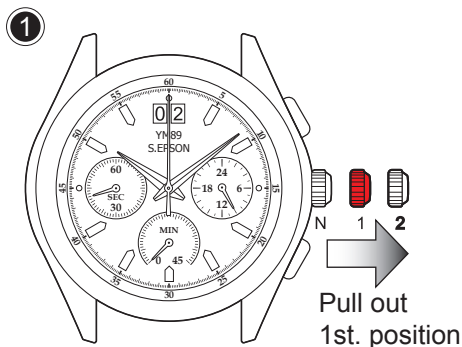

- Pull crown out to the 1st click position.

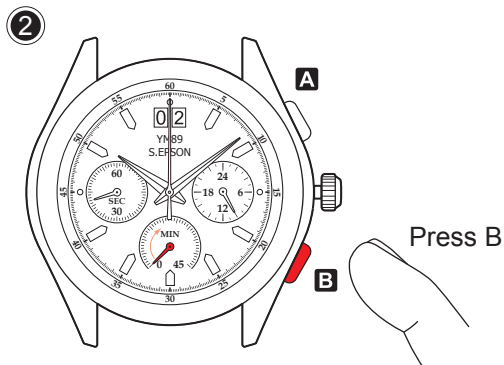

- Press button "B" for timer setting.
 - The timer can be set to a maximum of 45 minutes in 1 minute increments. The timer hand will back to "1" after count "45" minutes.
 - If the timer was used before, when the button "B" is pressed first, the timer hand jump to the previous timer setting time.

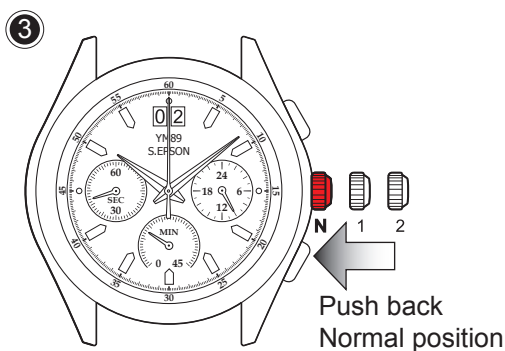

- Push crown back to normal position.

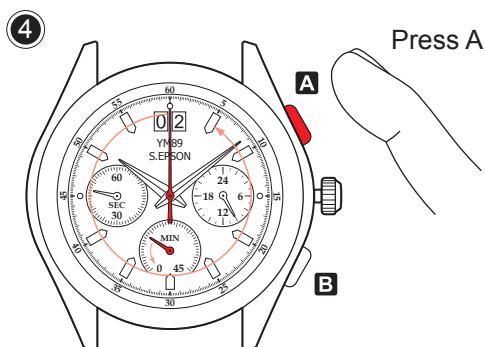

- Press button "A" to start timer function.
 - Under timer condition, 1/5 second center hand & 6H position timer hand turn counterclockwise.
 - 1/5 second center hand turns counterclockwise in 1 second increments.
 - While the countdown timer is working, the timer can be extend in 1 minute increments.

Note) Maximum of 45 minutes.

- ⑤ When the timer finishes counting down, the beep will start to sound from 3 seconds before till the time is up. (Timer Off)

Note)

The beep sound can be stopped if the button "A" or "B" are pressed.

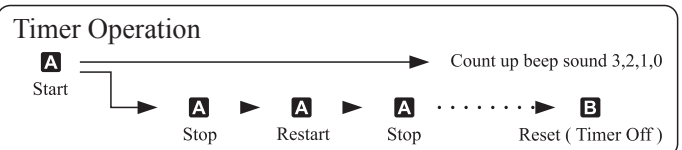

S.EPSON Products

JAPAN TECHNOLOGY & QUALITY

www.timemodule.com

CAL.YM89

1/5 SECOND CHRONOGRAPH WITH COUNTDOWN TIMER

5/6 Instructions

Timer Sound Demonstration:

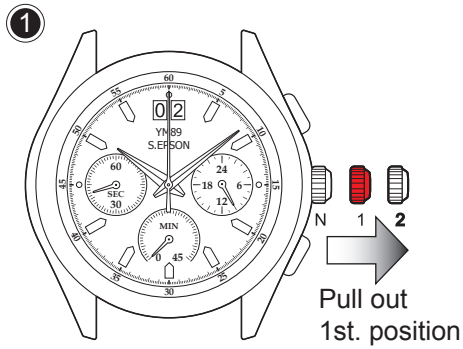

- Pull crown out to the 1st click position.

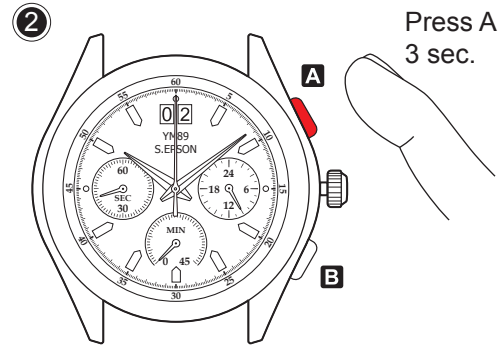

- Press button "A" more than 3 seconds.



S.EPSON Products

JAPAN TECHNOLOGY & QUALITY

www.timemodule.com

CAL.YM89

1/5 SECOND CHRONOGRAPH WITH COUNTDOWN TIMER

6/6
Instructions

Stopwatch Hand Position Adjustment:

If the Stopwatch hands are not in "0" position, follow the procedures below to set them.

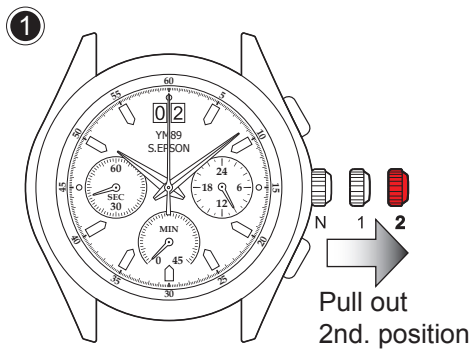

- Pull crown out to the 2nd click position.

Note: When the stopwatch has been measuring or is stopped, if the crown is pulled out to the 2nd. click position, it will automatically reset.

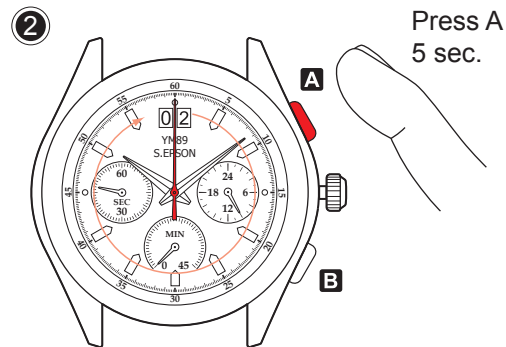

- Press button "A" for more than 5 seconds.
 - Stopwatch 1/5-second hand turns a full round and can now be set to correct position.

- Press button "B" repeatedly to set it to "0" position.

Note: Stopwatch 1/5-second hand moves quickly if button "B" is kept pressed.

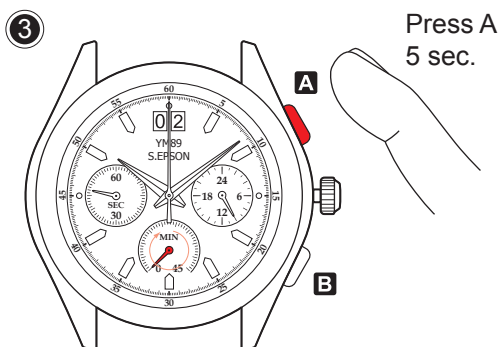

- Press button "A" for more than 2 seconds.
 - Stopwatch minute hand turns a full round and can now be set to correct position.
- Press button "B" repeatedly to set it to "0" position.

Note: Stopwatch minute hand moves quickly if button "B" is kept pressed.

When the stopwatch hand adjustment is activated, the stopwatch minute hand on 6H position turn full round clockwise direction.

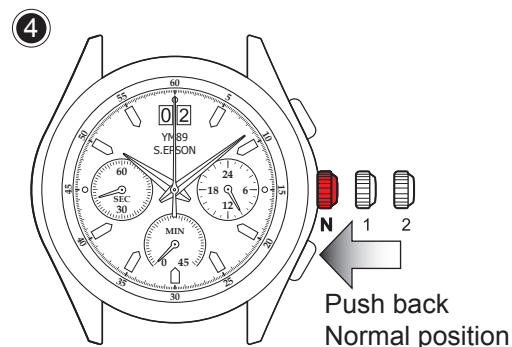

- Push crown back to normal position.



S.EPSON Products

JAPAN TECHNOLOGY & QUALITY

www.timemodule.com