

CAL.YM64

1/5 SECOND, ALARM CHRONOGRAPH

1/6 Instructions

Features

- ◆ 24-hour, Hour, Minute and Small second hands
- ◆ Date
- ◆ Alarm: Single time alarm
 - Can be set to ring only once at a designated time within the coming 12 hours.
- ◆ Stopwatch
 - 2 Stopwatch hands: 1/5-second and Minute hand.
 - The stopwatch can measure up to 59'59"8.
 - Sprit time measurement.

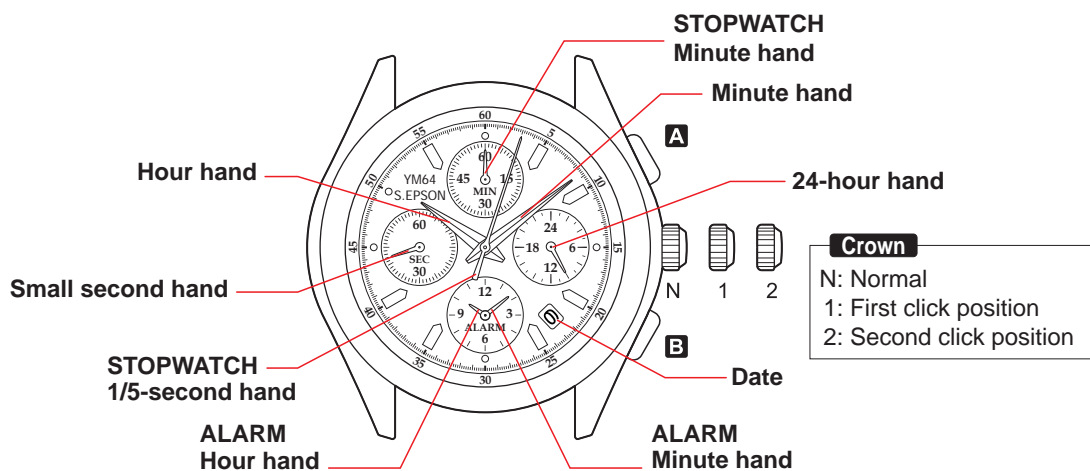

Movement size	12'''
Outside Diameter	27.60 mm (12H-6H) X 24.00 mm (3H-9H)
Casing Diameter	27.00 mm (12H-6H)
Height	4.34 mm (Including Battery)
Battery	SR927W
Battery Life Approx.	3 years

◆ Battery Life Indicator

When the battery nears its end, the small second hand moves at two-second intervals instead of normal one-second intervals. In that case, have the battery replaced with a new one as soon as possible.

Note: While the small second hand is moving at two-second intervals, the alarm will not ring even if it is engaged.

This is not a malfunction.

The watch remains accurate while the small second hand is moving at two-second intervals.



S.EPSON Products

JAPAN TECHNOLOGY & QUALITY

www.timemodule.com

CAL.YM64

1/5 SECOND, ALARM CHRONOGRAPH

2/6
Instructions

How to Set Time and Date:

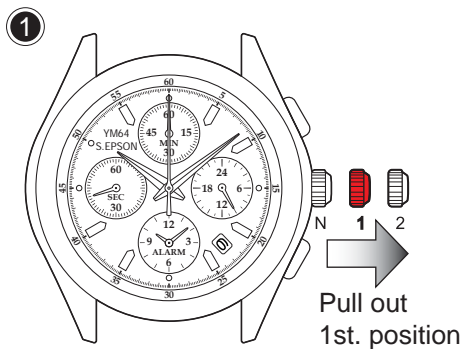

- Pull crown out to the 1st click position.

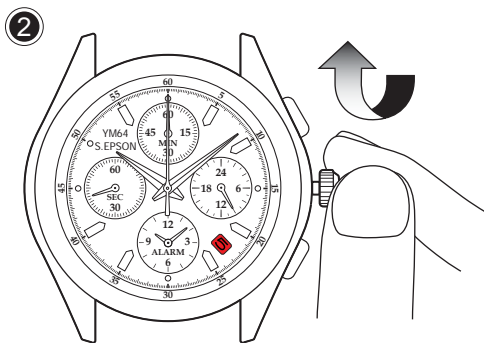

- Turn the crown clockwise until the previous day's date appears.

*Note: Do not set the date between 9:00 PM and 1:00 AM.
Otherwise, the date may not change properly.*

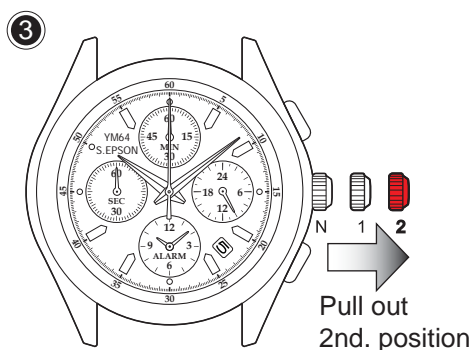

- Pull crown out to the 2nd click position when the second hand is at the 12 o'clock position.

Note: When the stopwatch has been measuring or is stopped, if the crown is pulled out to the 2nd. click position, it will automatically reset the Stopwatch hands to "0".

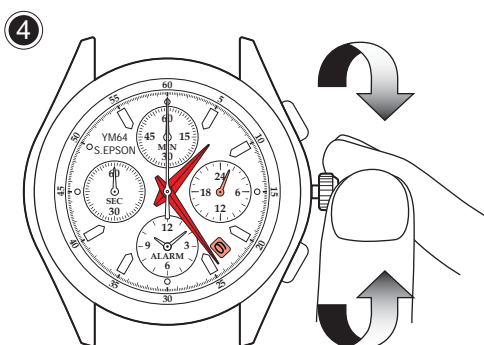

- Turn to set the Hour and Minute hands.
- Turn clockwise to advance the Hour and Minute hands past 12:00 AM. Doing so will advance the date to the current date.
- Set the Hour and Minute hands to the desired time taking AM or PM into consideration. You can confirm with 24 hour hand.

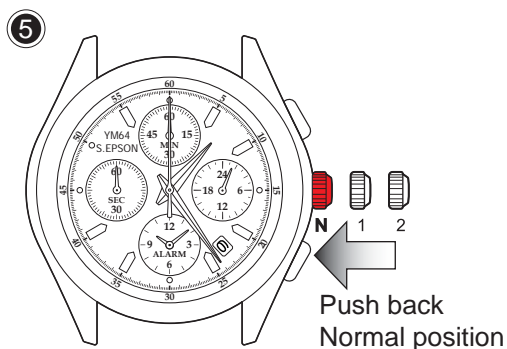

- Push crown back to normal position.

Recommend:

- The hands be set to the time a few minutes ahead of the current time, taking into consideration the time required to adjust the Stopwatch hands position if necessary.
- When setting the Minute hand, first advance it 4 to 5 minutes ahead of the desired time and then turn it back to the exact minute.



S.EPSON Products

JAPAN TECHNOLOGY & QUALITY

www.timemodule.com

CAL.YM64

1/5 SECOND, ALARM CHRONOGRAPH

3/6
Instructions

How to Set Alarm:

Before using the alarm, check that the Alarm hands are adjusted to the current time.

- The alarm can be set to ring only once at a designated time within the coming 12 hours.
- The alarm time can be set in one minute increments.

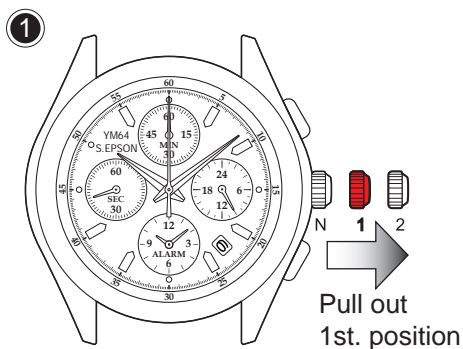

- Pull crown out to the 1st click position.

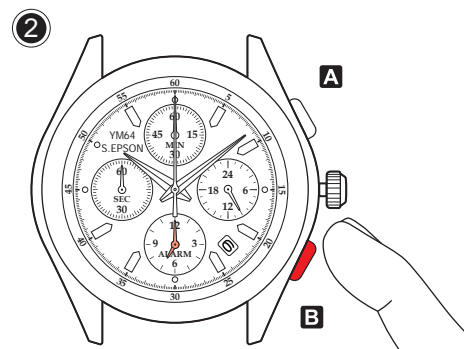

- Press button "B" repeatedly to set the Alarm hands to the desired alarm time.

Note: The Alarm hands move quickly if button "B" is kept pressed.

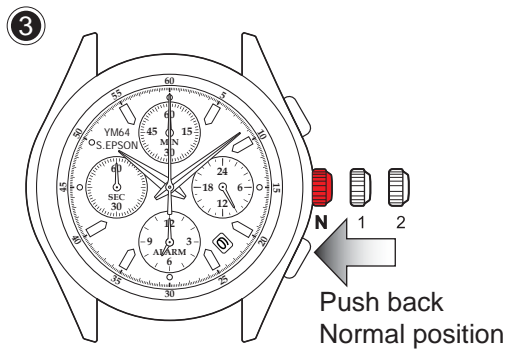

- Push crown back to normal position.

Note: The alarm is automatically engaged.

- The single-time alarm cannot be set for a time more than 12 hours ahead of the current time. While you keep button "B" pressed to advance the Alarm hands quickly, they stop when they indicate the current time and the alarm is disengaged. In that case, release button "B", and then, press and hold the button again to set the Alarm hands to the desired time.
- While the crown is at the normal position, the Alarm hands indicate the current time when the alarm is disengaged and the designated alarm time when it is engaged.

Note: If the Alarm hands are not adjusted to the current time, follow the procedure in "Alarm Hand and Stopwatch Hand Position Adjustment".



S.EPSON Products

JAPAN TECHNOLOGY & QUALITY

www.timemodule.com

CAL.YM64

1/5 SECOND, ALARM CHRONOGRAPH

How to Stop the Alarm:

At the designated time the alarm rings for 20 second, and it is automatically disengaged as it stops. To stop it manually, press any button.

- While the stopwatch is measuring, the alarm rings differently than usual. However, this is not a malfunction.
- While the alarm is ringing, pressing any button will only stop the alarm, and no stopwatch operation can be made.

How to Cancel the Alarm Time You Have Set:

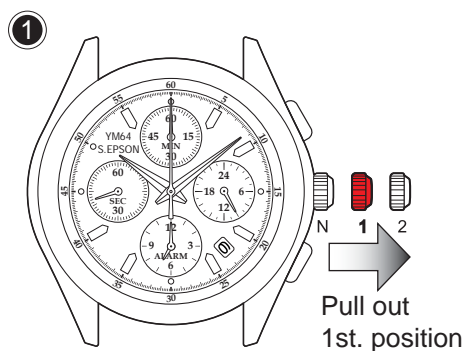

- Pull crown out to the 1st click position.

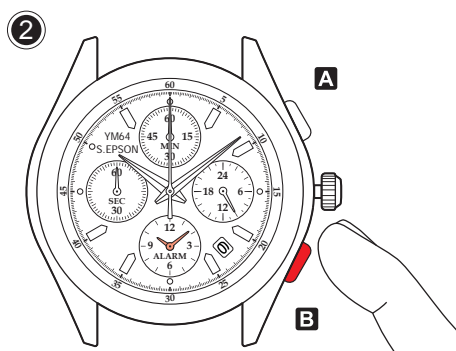

- Press and hold button “B” until Alarm hands stop and indicate the current time.

Note: The Alarm hands move quickly if button “B” is kept pressed.

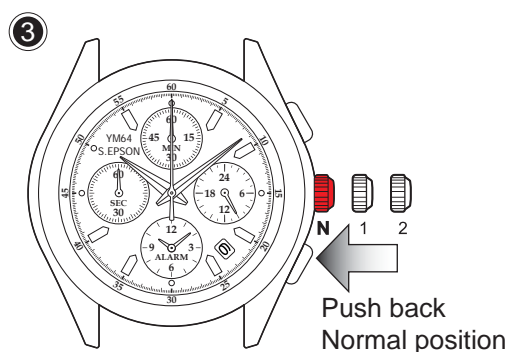

- Push crown back to normal position.

Note: The alarm is automatically engaged.



S.EPSON Products

JAPAN TECHNOLOGY & QUALITY

www.timemodule.com

CAL.YM64

1/5 SECOND, ALARM CHRONOGRAPH

5/6 Instructions

How to Use Stopwatch Functions:

The stopwatch can measure up to 59'59"80 in 1/5 second increments.

After 60 minutes, it will start counting again from "0" repeatedly to 12 hours.

When the measurement reaches 12 hours, the stopwatch automatically stops counting.

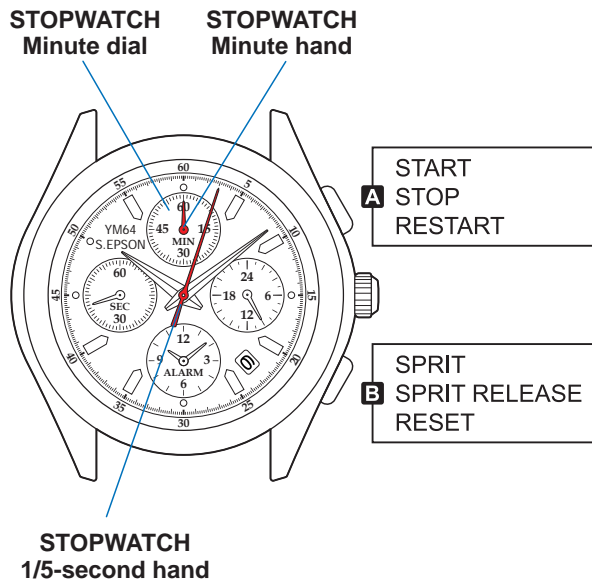

Standard Measurement

A ▶ **A** ▶ **B**
Start Stop Reset

Accumulated Elapsed Time Measurement

A ▶ **A** ▶ **A** ▶ **A** ▶ **B**
Start Stop Restart Stop Reset

Note: Restart and stop of the stopwatch can be repeated by pressing button A.

Sprit Time Measurement

A ▶ **B** ▶ **B** ▶ **A** ▶ **B**
Start Sprit Sprit Release Stop Reset

Note: Measurement and release of sprit time can be repeated by pressing button B.

Measurement of Two Competitors

A ▶ **B** ▶ **A** ▶ **B** ▶ **B**
Start Finish Time of 1st Competitor 2nd Competitor Finishes Finish Time of 2nd Competitor Reset

- Stopwatch 1/5-second hand is capable of timing 12 hours. (60 seconds x 720 times)
- Stopwatch minute hand is capable of timing 12 hours. (60 minutes x 12 times)

* Before using the stopwatch, be sure to check that the crown is set at the normal position and that the Stopwatch hands are reset to the "0" position.

Note: If the Stopwatch hands do not return to the "0" position when the stopwatch is reset to "0", follow the procedure in "Alarm Hand and Stopwatch Hand Position Adjustment".



S.EPSON Products

JAPAN TECHNOLOGY & QUALITY

www.timemodule.com

CAL.YM64

1/5 SECOND, ALARM CHRONOGRAPH

6/6 Instructions

Alarm Hand and Stopwatch Hand Position Adjustment:

Set the Alarm hands to the time the main time hands indicate.

Before using the alarm, check that the Alarm hands are adjusted.

If the Stopwatch hands are not in "0" position, follow the procedures below to set them to "0" position.

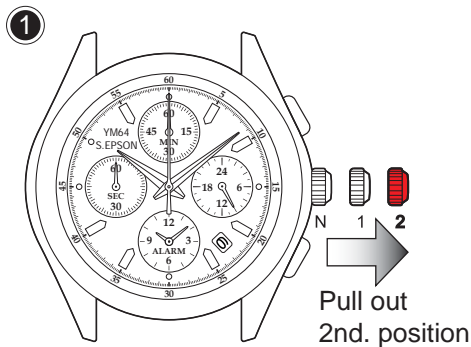

- Pull crown out to the 2nd click position when the second hand is at the 12 o'clock position.

Note: When the stopwatch has been measuring or is stopped, if the crown is pulled out to the 2nd. click position, it will automatically reset.

If the alarm has been set and the crown is pulled out to the 2nd. click position, the Alarm hands will turn to indicate the current time.

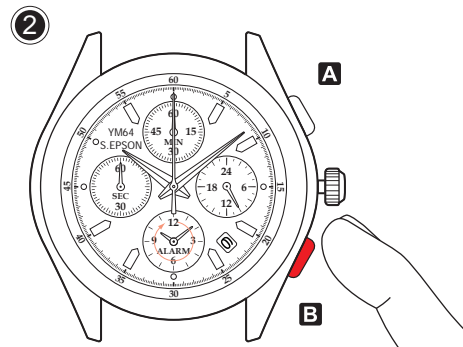

- Press button "B" repeatedly to set the Alarm hands to the time the main time hands indicate.

Note: The Alarm hands move quickly if button "B" is kept pressed.

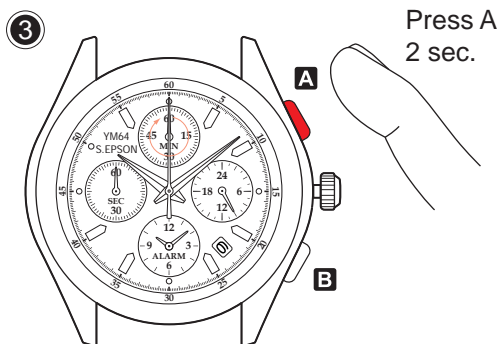

- Press button "A" for 2 seconds.
 - Stopwatch minute hand turns a full round and can now be set to correct position.
- Press button "B" repeatedly to set it to "0" position.

Note: Stopwatch minute hand moves quickly if button "B" is kept pressed.

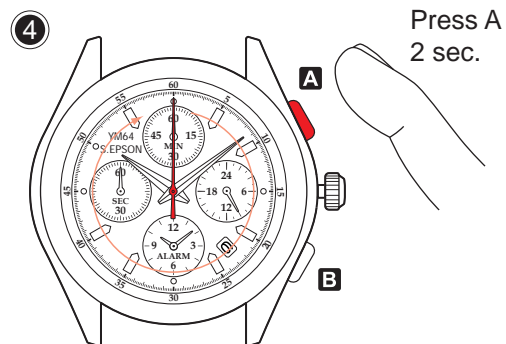

- Press button "A" for 2 seconds.
 - Stopwatch 1/5-second hand turns a full round and can now be set to correct position.
- Press button "B" repeatedly to set it to "0" position.

Note: Stopwatch 1/5-second hand moves quickly if button "B" is kept pressed.

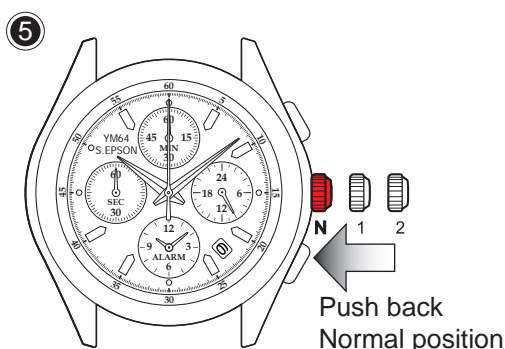

- Push crown back to normal position.

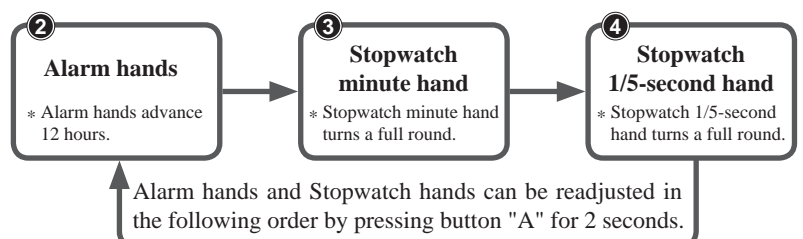

Note: If the watch is not indicating the current time, please refer to "How to set time" and set time.



S.EPSON Products

JAPAN TECHNOLOGY & QUALITY

www.timemodule.com