

CAL.YM12

1/5 SECOND CHRONOGRAPH

1/4

Instructions

Features

- ◆ 24-hour, Hour, Minute and Small second hands
- ◆ Date
- ◆ Stopwatch
 - 2 Stopwatch hands: 1/5-second and Minute hand.
 - The stopwatch can measure up to 59'59"8.
 - Sprit time measurement.

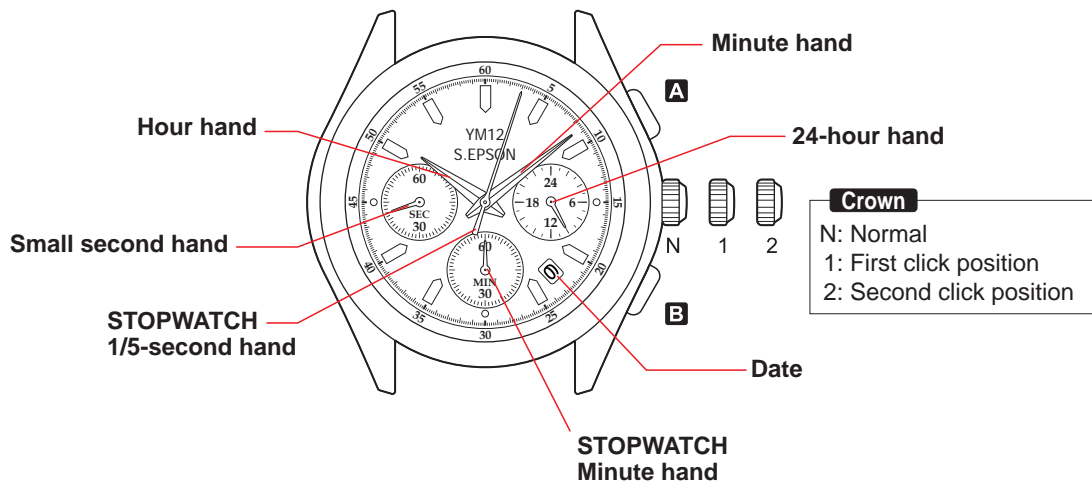

Movement size	12'''
Outside Diameter	27.60 mm (12H-6H) X 24.00 mm (3H-9H)
Casing Diameter	27.00 mm (12H-6H)
Height	4.34 mm (Including Battery)
Battery	SR927SW
Battery Life Approx.	5 years

- ◆ **Battery Life Indicator**
 When the battery nears its end, the small second hand moves at two-second intervals instead of normal one-second intervals. In that case, have the battery replaced with a new one as soon as possible.

Note: The watch remains accurate while the small second hand is moving at two-second intervals.



S.EPSON Products

JAPAN TECHNOLOGY & QUALITY

www.timemodule.com

How to Set Time and Date:

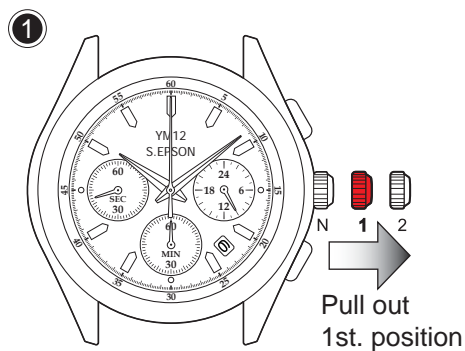

- Pull crown out to the 1st click position.

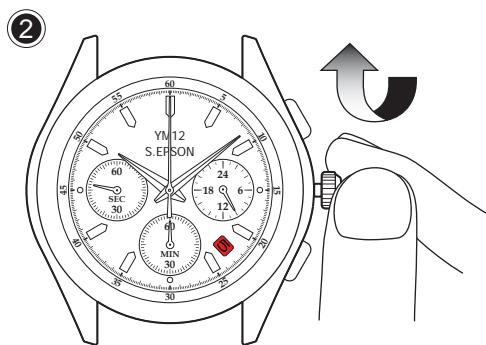

- Turn the crown clockwise until the previous day's date appears.

Note: Do not set the date between 9:00 PM and 1:00 AM. Otherwise, the date may not change properly.

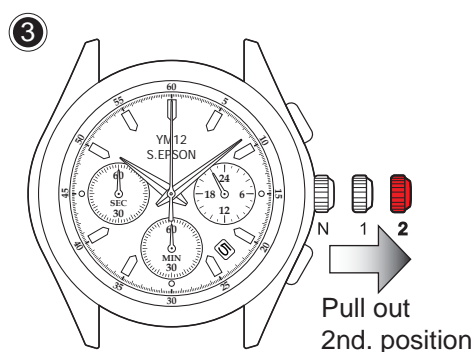

- Pull crown out to the 2nd click position when the second hand is at the 12 o'clock position.

Note: When the stopwatch has been measuring or is stopped, if the crown is pulled out to the 2nd. click position, it will automatically reset the Stopwatch hands to "0".

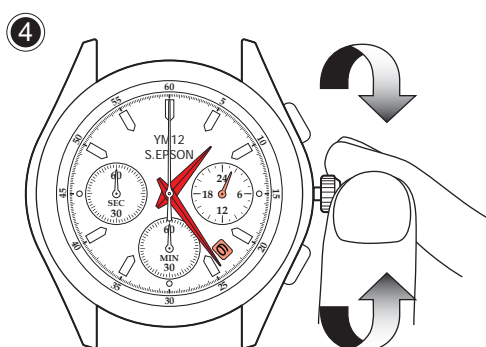

- Turn to set the Hour and Minute hands.
- Turn clockwise to advance the Hour and Minute hands past 12:00 AM. Doing so will advance the date to the current date.
- Set the Hour and Minute hands to the desired time taking AM or PM into consideration. You can confirm with 24 hour hand.

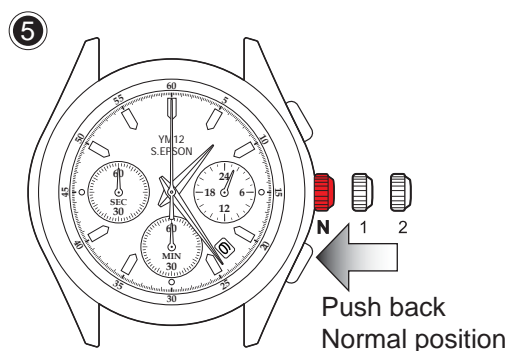

- Push crown back to normal position.

Recommend:

- The hands be set to the time a few minutes ahead of the current time, taking into consideration the time required to adjust the Stopwatch hands position if necessary.
- When setting the Minute hand, first advance it 4 to 5 minutes ahead of the desired time and then turn it back to the exact minute.



S.EPSON Products

JAPAN TECHNOLOGY & QUALITY

www.timemodule.com

CAL.YM12

1/5 SECOND CHRONOGRAPH

3/4

Instructions

How to Use Stopwatch Functions:

The stopwatch can measure up to 59'59"80 in 1/5 second increments.

When the measurement reaches 12 hours, the stopwatch automatically stops counting.

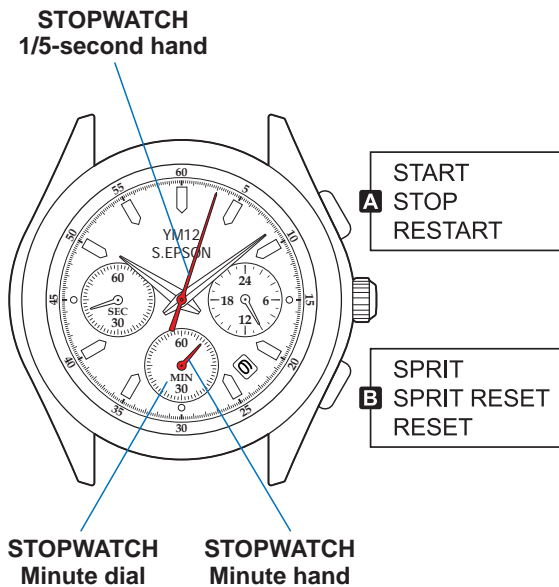

Standard Measurement



Accumulated Elapsed Time Measurement

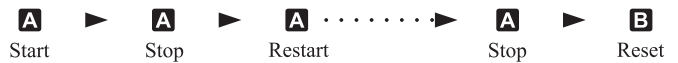

Note: Restart and stop of the stopwatch can be repeated by pressing button A.

Sprit Time Measurement



Note: Measurement and release of sprit time can be repeated by pressing button B.

Measurement of Two Competitors



- 1/5-second hand is capable of timing 12 hours. (60 seconds x 720 times)
- Minute hand is capable of timing 12 hours. (60 minutes x 12 times)

* Before using the stopwatch, be sure to check that the crown is set at the normal position and that the Stopwatch hands are reset to the "0" position.

Note: If the Stopwatch hands do not return to the "0" position when the stopwatch is reset to "0", follow the procedure in "Stopwatch Hand Position Adjustment".



S.EPSON Products

JAPAN TECHNOLOGY & QUALITY

www.timemodule.com

Stopwatch Hand Position Adjustment:

If the Stopwatch hands are not in "0" position, follow the procedures below to set them.

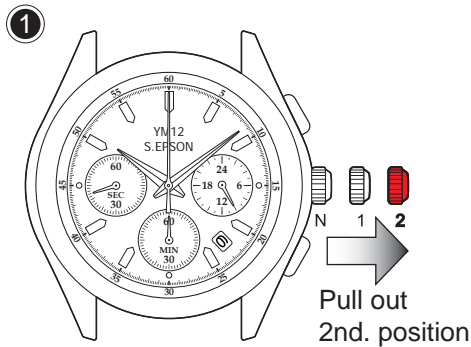

- Pull crown out to the 2nd click position.

Note: When the stopwatch has been measuring or is stopped, if the crown is pulled out to the 2nd. click position, it will automatically reset.

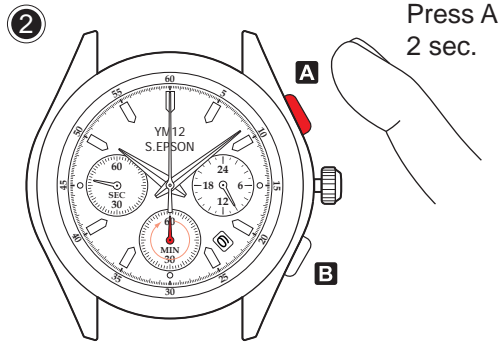

- Press button "A" for 2 seconds.
 - Stopwatch minute hand turns a full round and can now be set to correct position.

- Press button "B" repeatedly to set it to "0" position.

Note: Stopwatch minute hand moves quickly if button "B" is kept pressed.

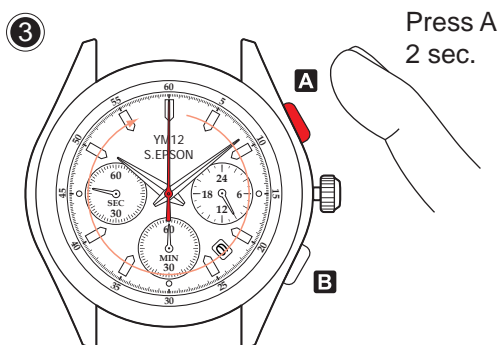

- Press button "A" for 2 seconds.
 - Stopwatch 1/5-second hand turns a full round and can now be set to correct position.
- Press button "B" repeatedly to set it to "0" position.

Note: Stopwatch 1/5-second hand moves quickly if button "B" is kept pressed.

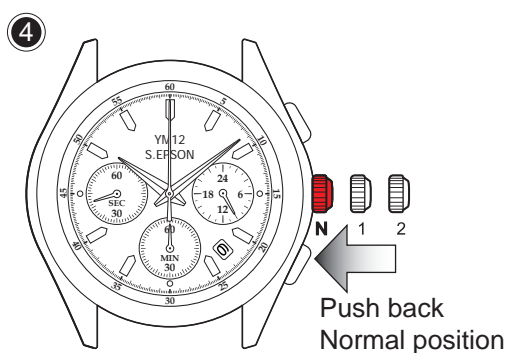

- Push crown back to normal position.