



Cal. VX36B

ϕ 23.3 mm
H 3.05 mm

Items	Rev.	Page
Specifications	00	1
Appearance	01	2
Casing	02	3
Hand fitting	03	4
Hand setting stem	00	5
Dial	00	6
Casing ring	00	7

Date: 15/Sep/'09

S.EPSON Products

MOVEMENT SPECIFICATIONS

CAL. VX36B

Analog Quartz 10 1/2" Slim Movement
3 hands (H/M/S) and 2 eyes with Day / Date indicators

1. MOVEMENT DIMENSIONS

*Outside diameter	ϕ 24.00mm × 21.50mm(3-9H) × 21.50mm(12-6H)
*Casing diameter	ϕ 23.30mm × 21.30mm(3-9H) × 21.50mm(12-6H)
*Total height	3.05mm (including battery)

2. TIME STANDARD

*Type of quartz oscillator	Tuning fork
*Frequency of quartz oscillator	32,768 Hz
*Accuracy	±20 seconds per month (on wrist)
*Operating temperature range	-5°C to +50°C
*Regulation device	Nil (Pre-adjusted)

3. INDICATOR / FUNCTIONS

*3 Hands	Hour / Minute / Second
*2 Small hands	Day / Date
*Reset switch	
*Setting mechanism	Crown at normal position : Free Crown pulled out 1st click : Instant date change Crown pulled out 2nd click : Time setting (Day change) / Reset

4. FEATURES

*Jewels	1 Jewel
*Anti-magnetism	Over 1600A/m (Direct current magnetic field)
*Maximum unbalance of hands	Second hand : 0.06 μ N·m Minute hand : 0.64 μ N·m

5. BATTERY

*Type / Size	Silver oxide battery / ϕ 9.5mm × t 1.6mm
*Recommended battery	SR916SW (Maxell, Panasonic, Sony, Seizaiken)
*Nominal voltage	1.55 V
*Battery life	Approx. 3 years
*Driving current consumption	Approx. 0.85 μ A
*Operation stopping voltage	0.9 V

6. SEPARATED PARTS (Parts code)

*Hand setting stem	0354531 or 0354534
*Battery	SR916SW

7. TEST OF ACCURACY

*Equipment to be used	SEIKO quartz tester QT-99, Greiner quartz timer-C , Witschi Q-tester 4000
*Duration of measurement	10 seconds
*Microphone to be used	Electromagnetic detection type

All specifications are subject to change without notice.

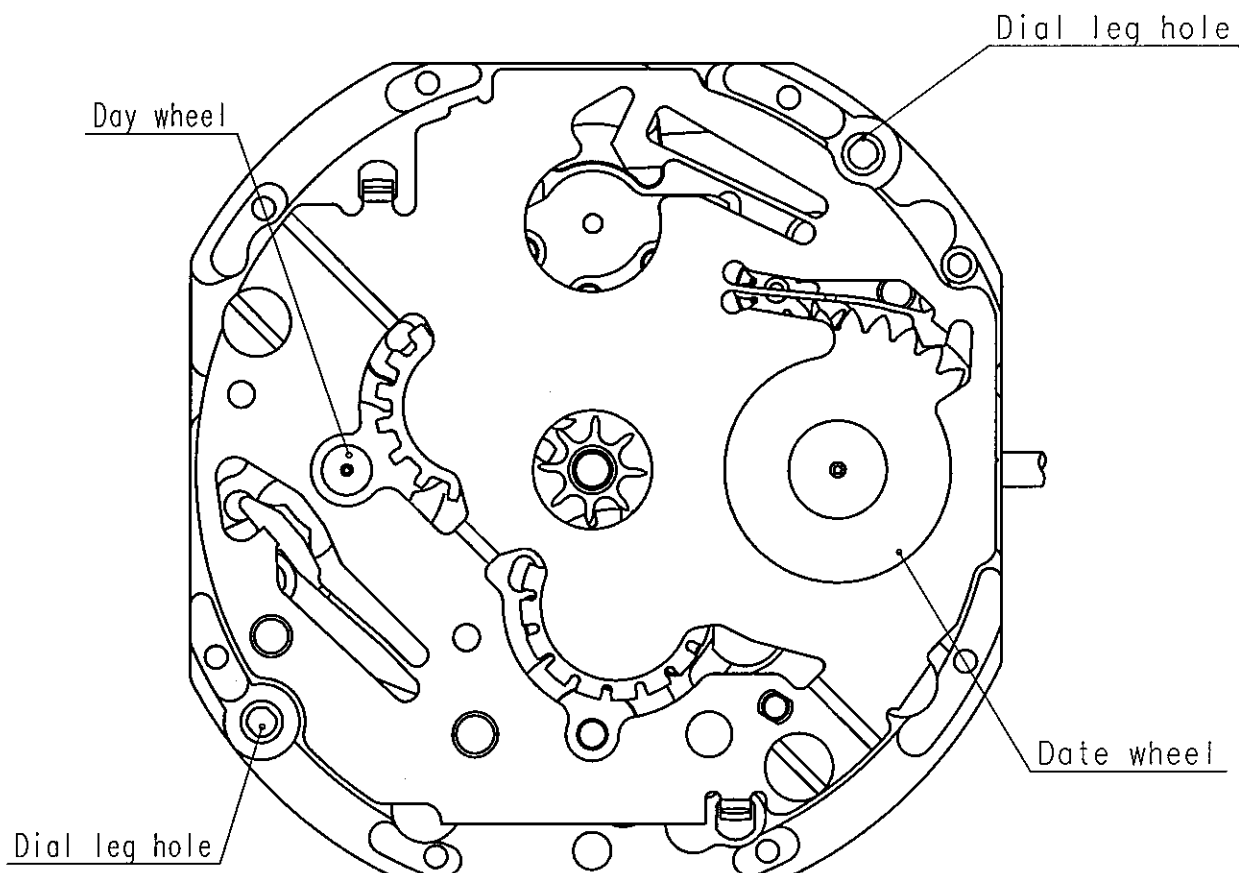
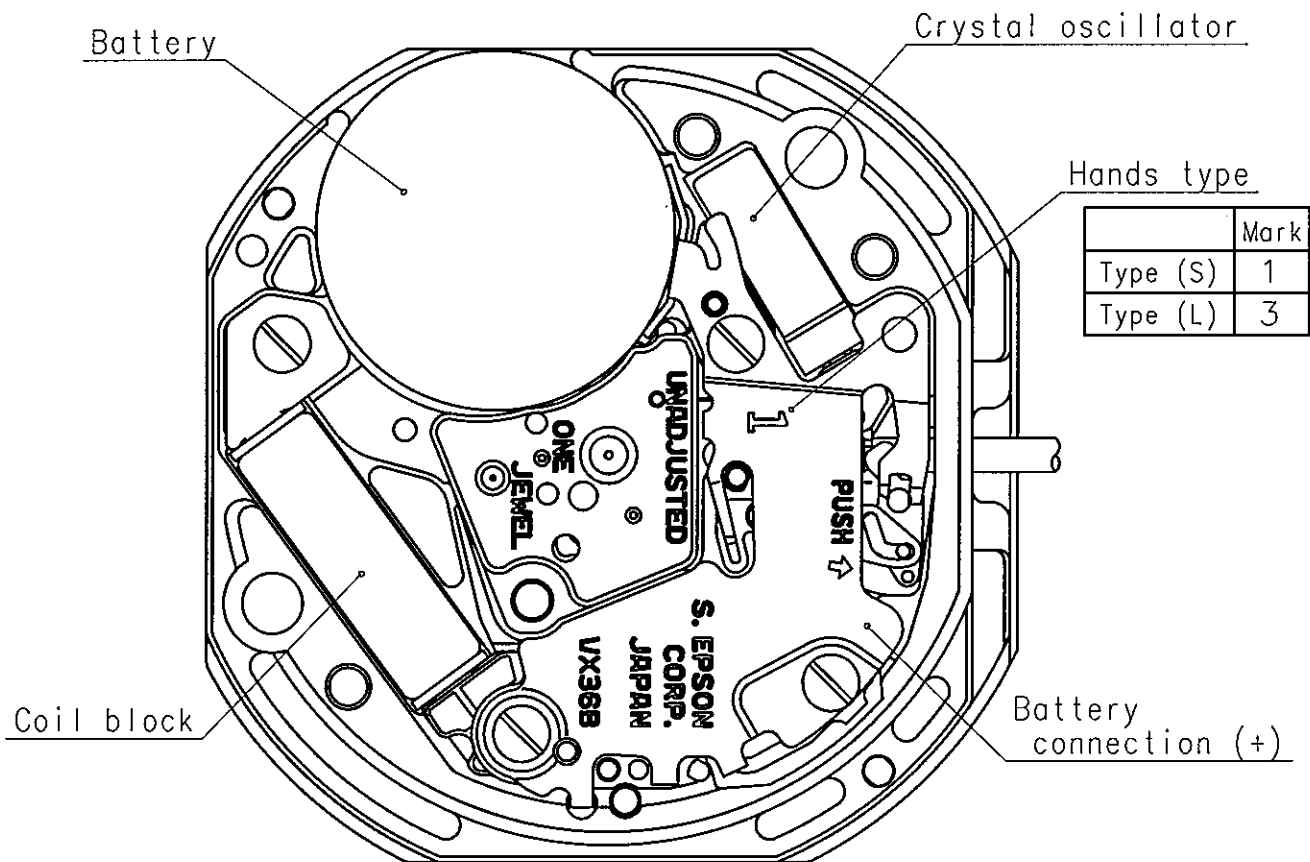

- * Minute hand unbalance $\leq 0.64 \mu \text{ N} \cdot \text{m}$ ($65 \mu \text{ g} \cdot \text{m}$)
- * Second hand unbalance $\leq 0.06 \mu \text{ N} \cdot \text{m}$ ($6 \mu \text{ g} \cdot \text{m}$)

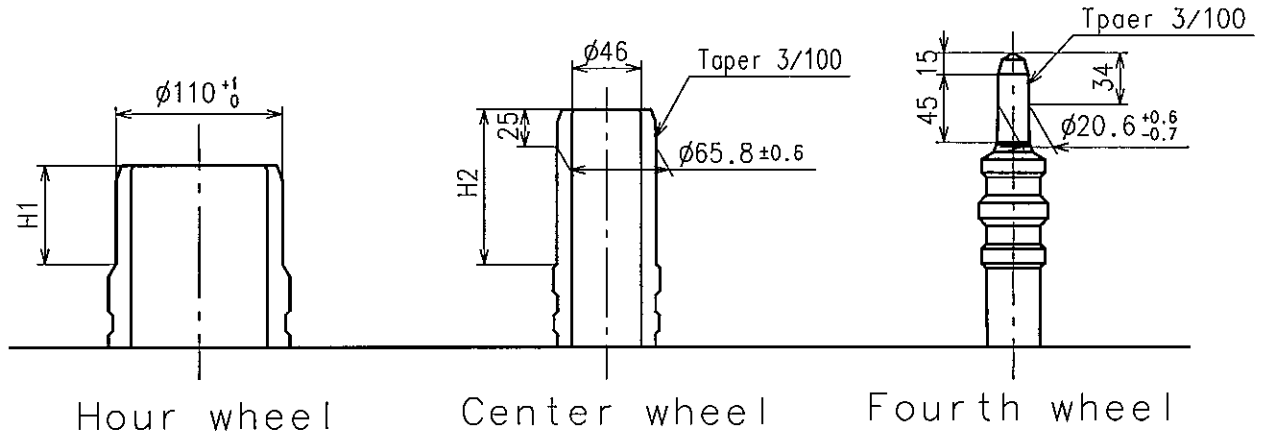

	Parts No.			Dimension	
	Hour wheel	Center wheel	Fourth wheel	H1	H2
Type S (1) VX36B1	0271538	0221537	0241537	65	103
Type L (3) VX36B2	0271579	0221592	0241563	65	141

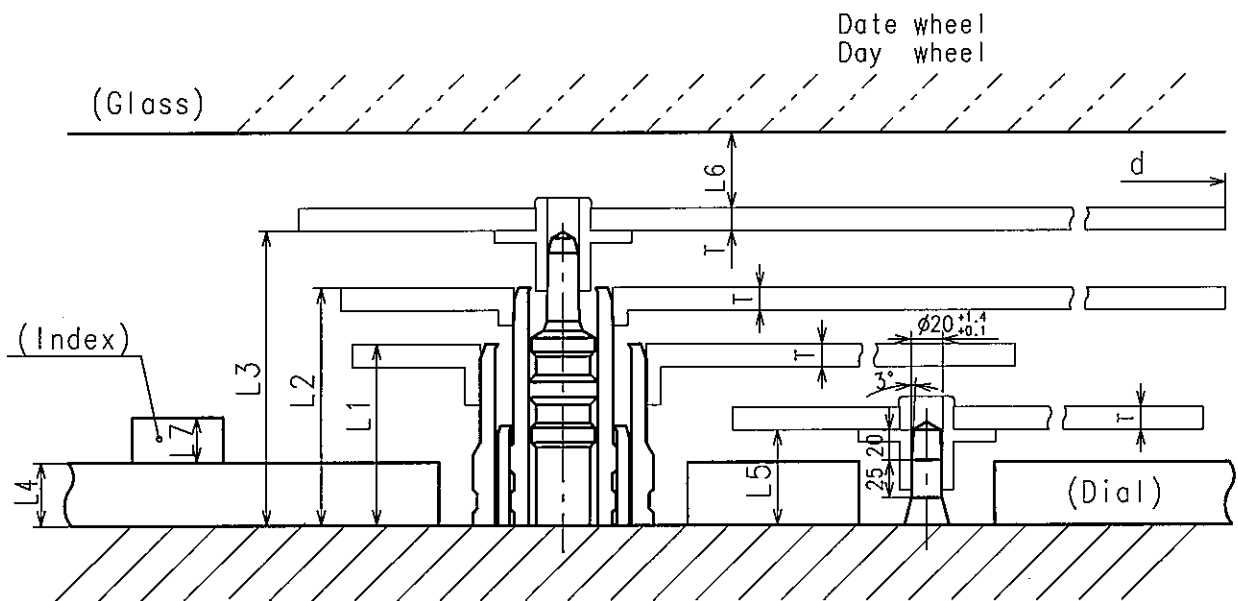

	L1	L2	L3	L4	L5	L6	L7	T	d
Type S (1) VX36B1	120	157	180	40	63	MIN: 50	MAX: 30	15	MAX: $\phi 2500$
Type L (3) VX36B2	156	195	220	70	99	MIN: 50	MAX: 30	15	MAX: $\phi 2500$

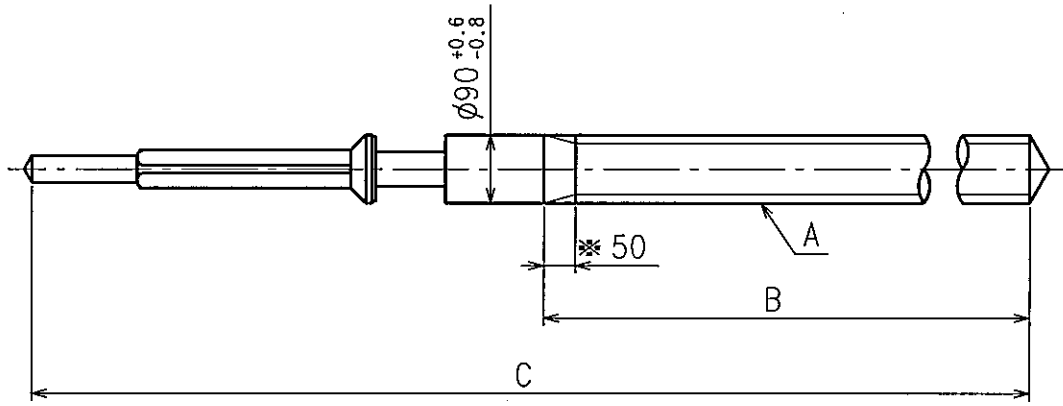

* Not threaded

	Part No.	A	B	C
Standard Type 1	0354531	$\phi 90$ P22.5	1225	1904
Type 2	0354534	$\phi 90$ P22.5	1500	3055

Material : Steel

Hardness : Vickers 600 ± 50

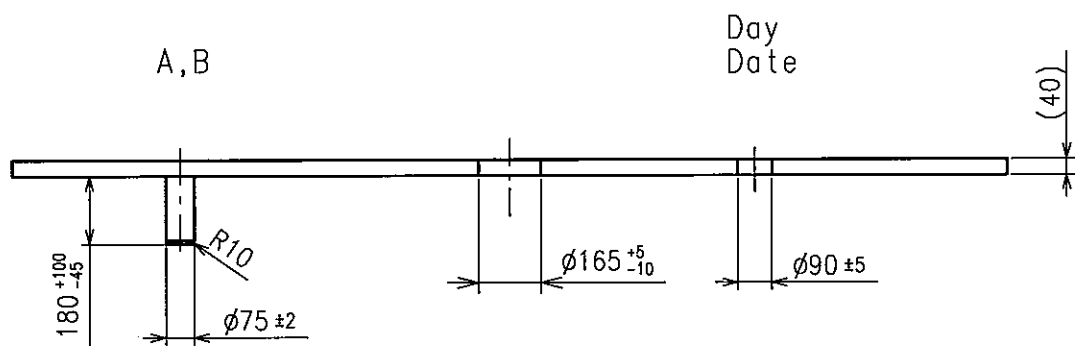
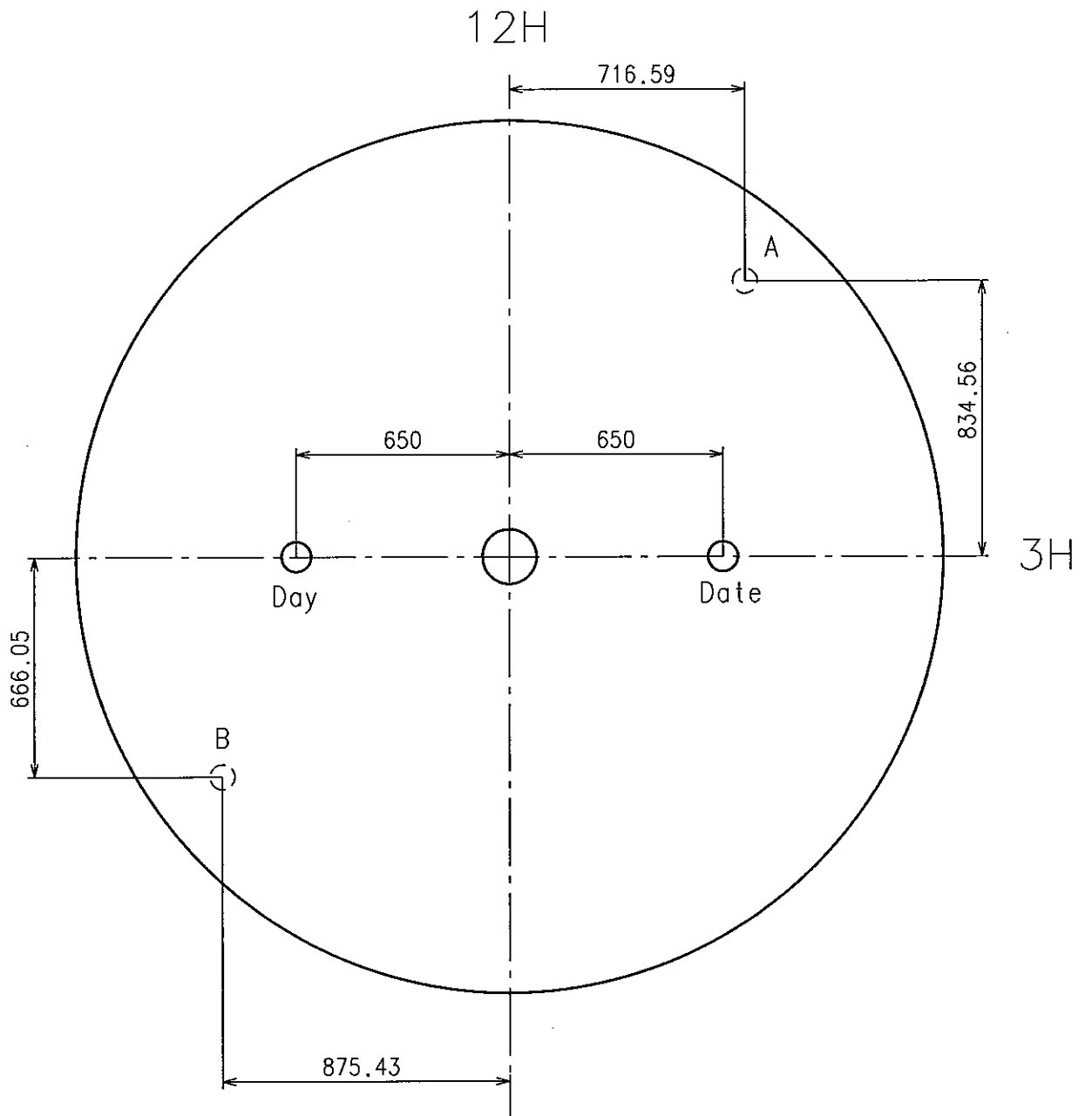

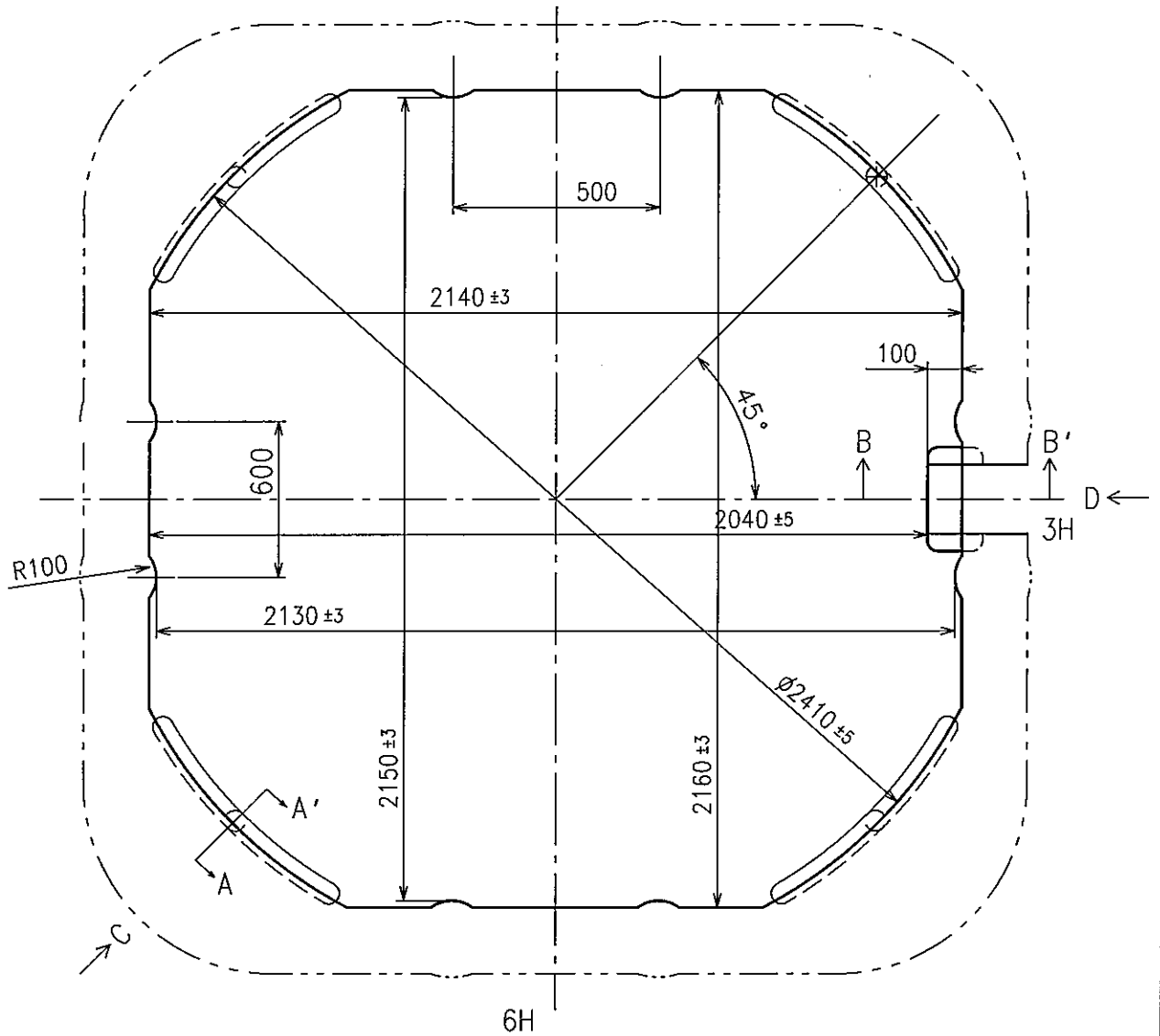

B-B' section

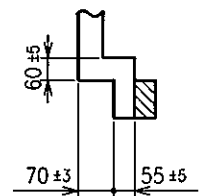

D view

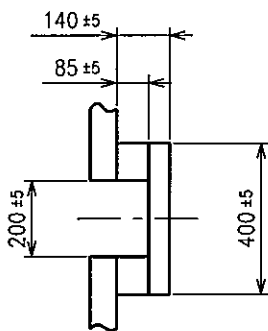

A-A' section

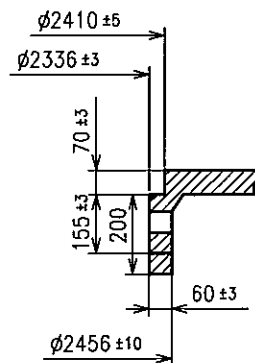

C view

